

DESIGN

PURCHASE

CONSTRUCT

ENJOY

OZCO Project #110 - Estate Wooden Mailbox Post Assembly with Post Base

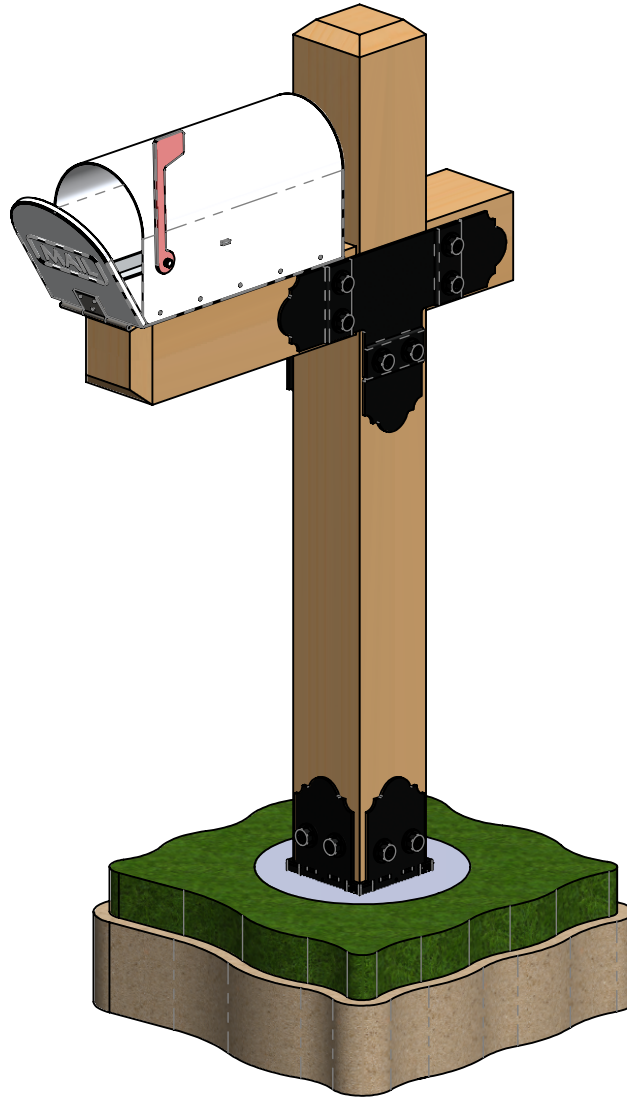

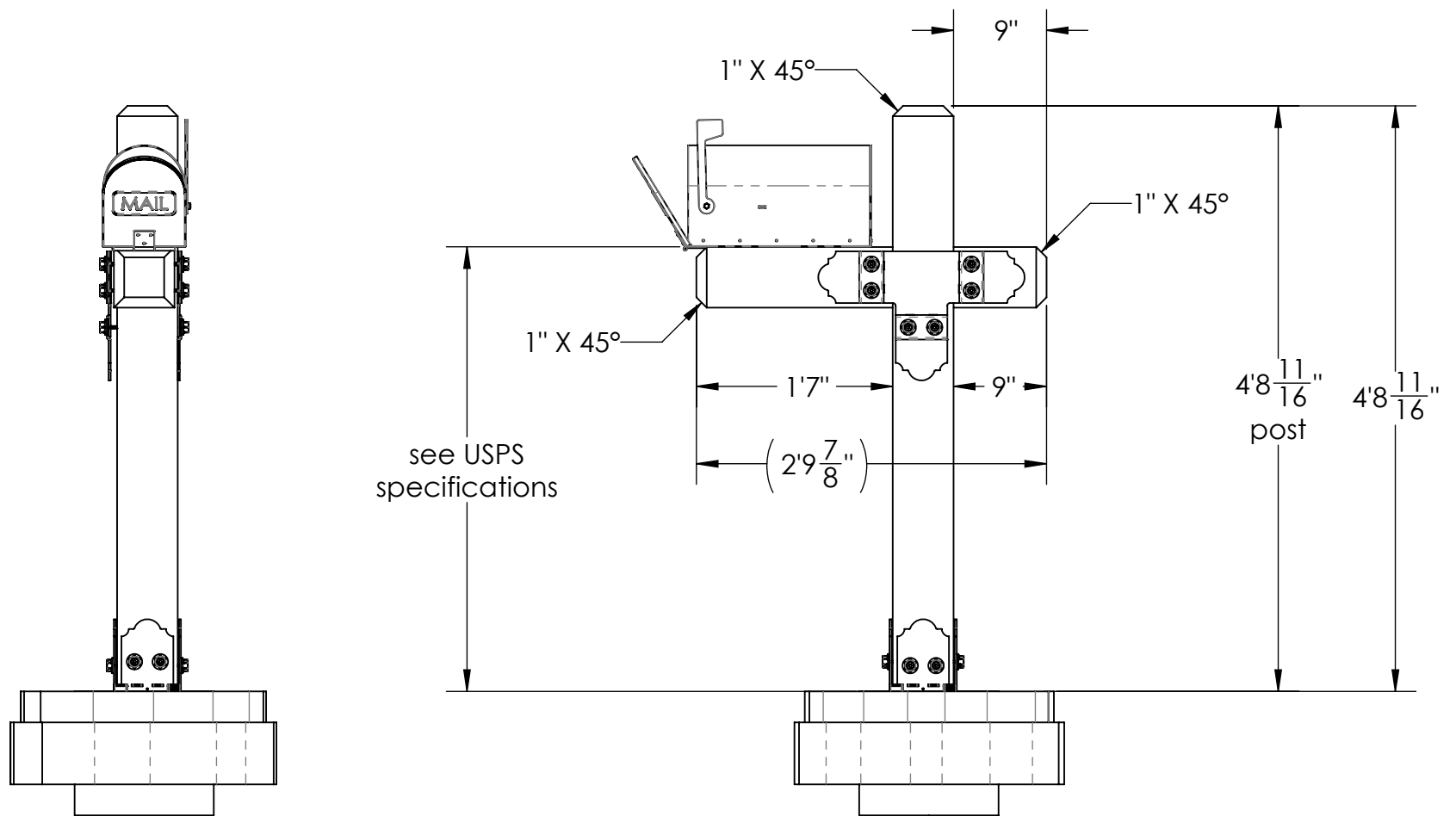

Overview

OZCO Project #110 - Estate Wooden Mailbox Post Assembly with Post Base

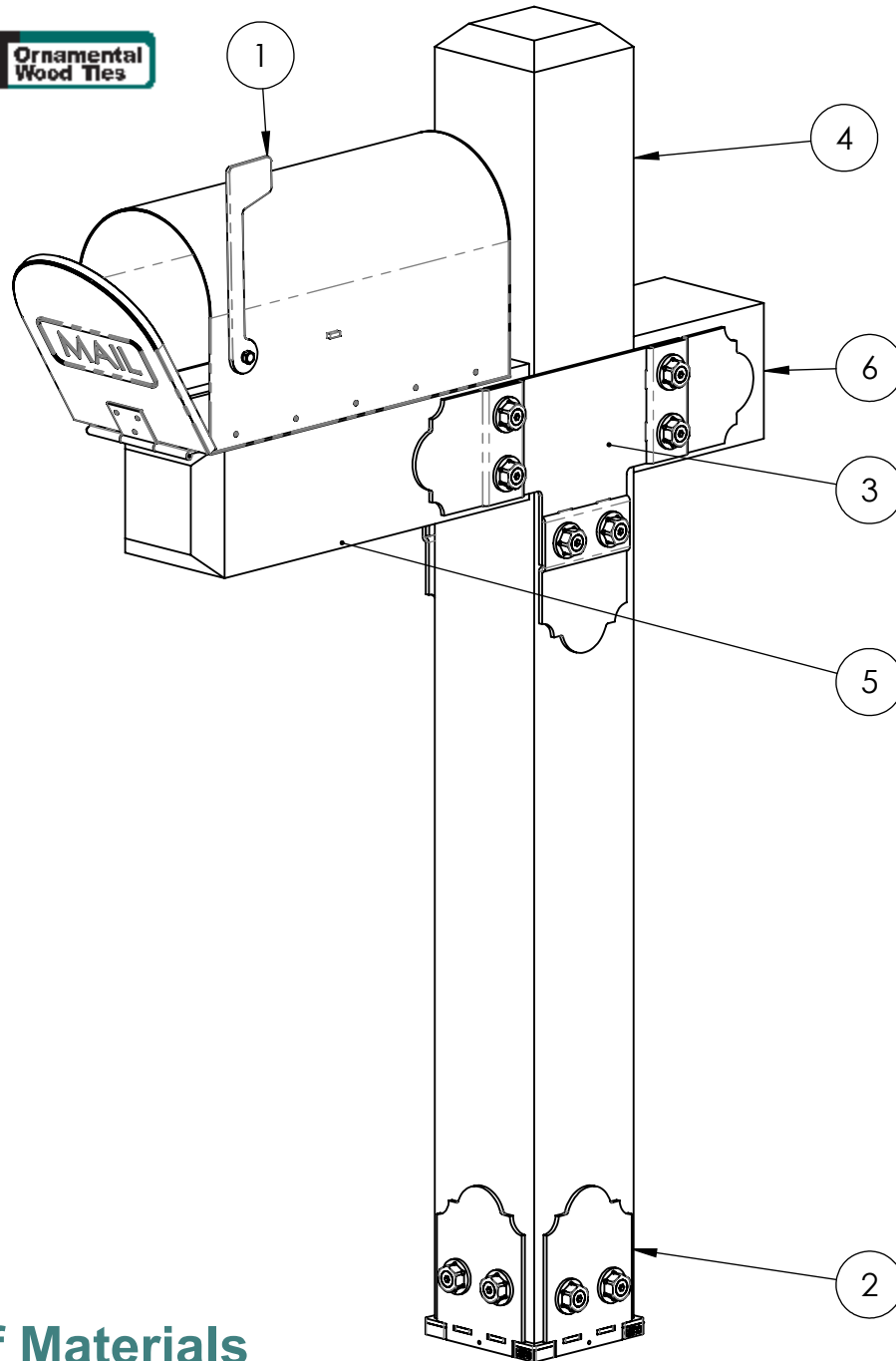

ITEM NO.	QTY.	PART NUMBER	DESCRIPTION
1	1	mailbox	
2	1	56608	6x6 Post Base Kit (6X6-PB-LS)
3	1	56612	"T" Tie Plate (TTP)
	3	56611	Truss Accent (TA-LS)
4	1	6x6 Cedar Post	6x6x4'8"
5	1	6x6 Cedar Post	6x6x1'7"
6	1	6x6 Cedar Post	6x6x9"

Bill of Materials

OZCO Project #110 - Estate Wooden Mailbox Post Assembly with Post Base

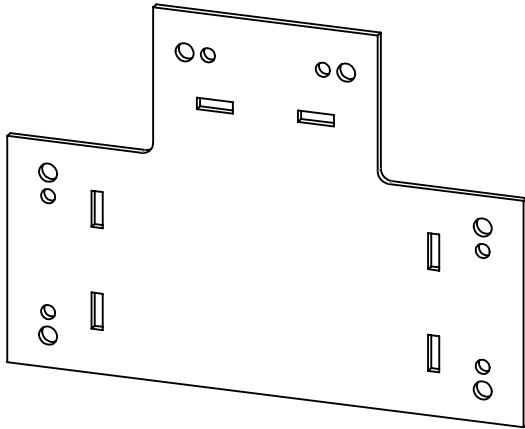

56612

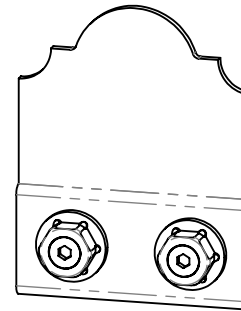

56611

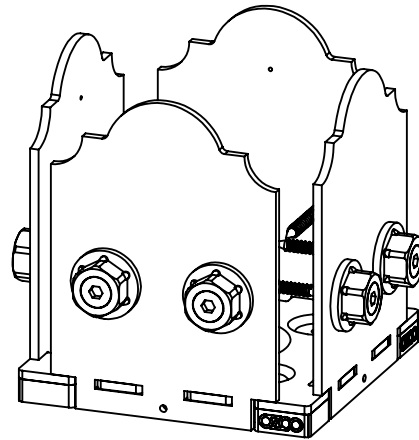

56608

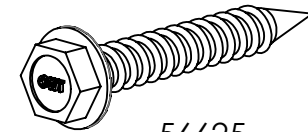

56625

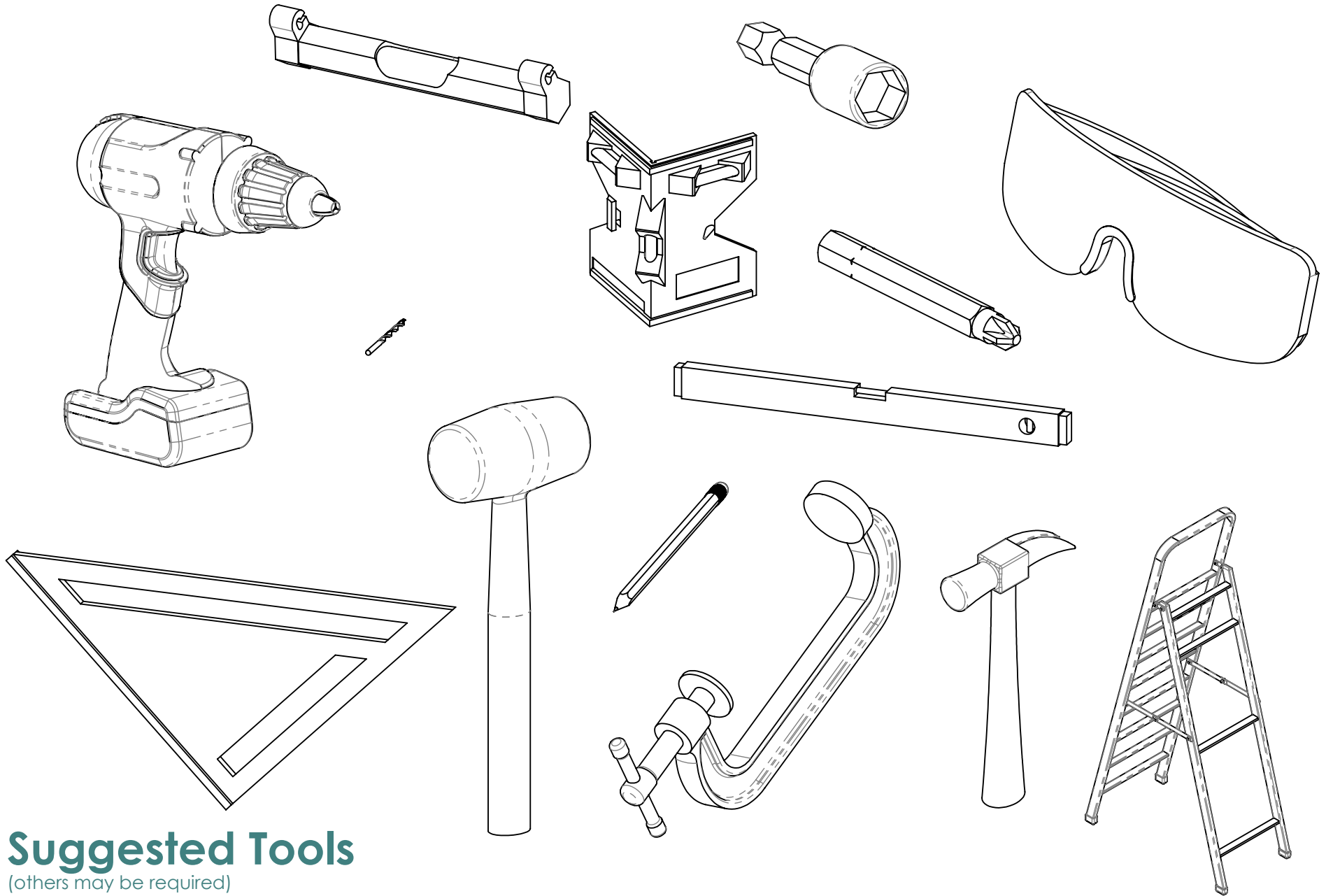

Suggested Tools

(others may be required)

OZCO Project #110 - Estate Wooden Mailbox Post Assembly with Post Base

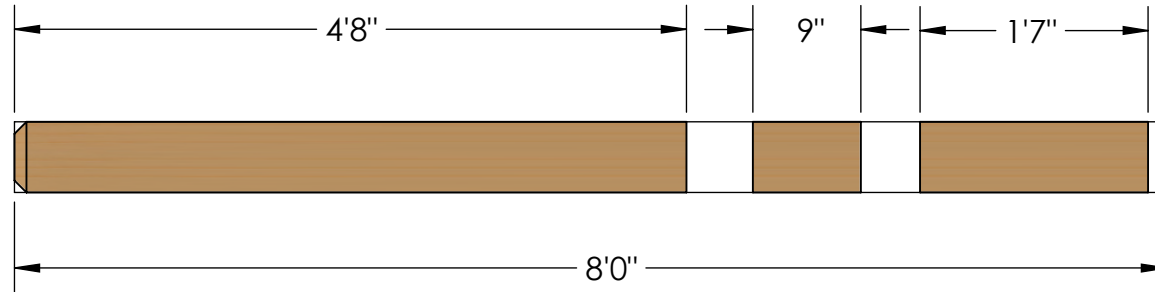

6x6x8 Post
(cut all wood from 1 post)

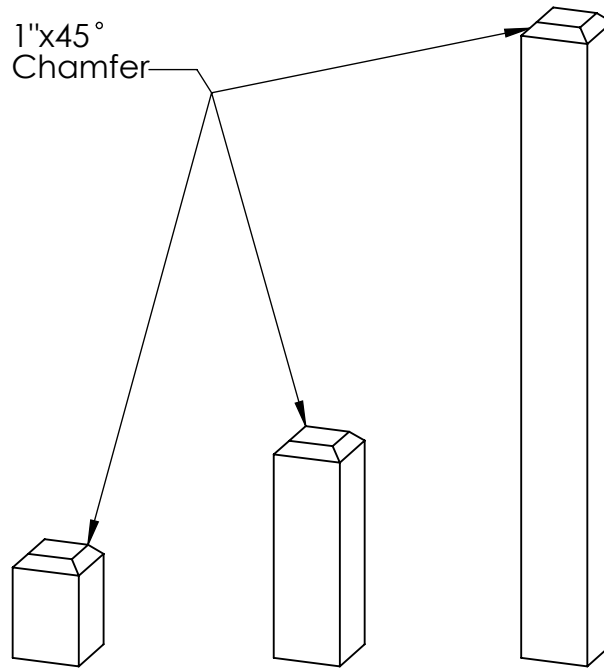

Cutlist

OZCO Project #110 - Estate Wooden Mailbox Post Assembly with Post Base

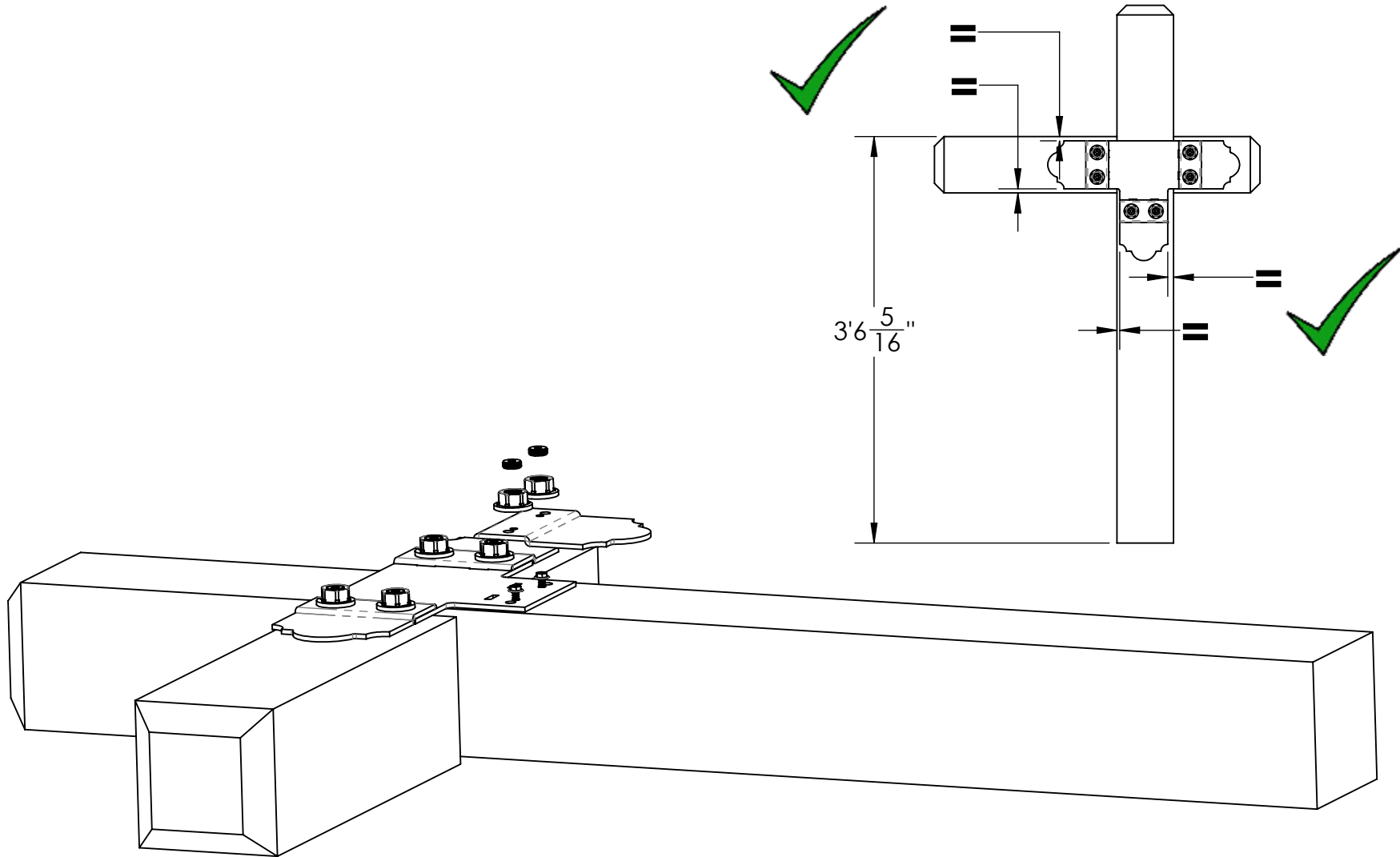

assemble on flat non-marring surface

step 1

OZCO Project #110 - Estate Wooden Mailbox Post Assembly with Post Base

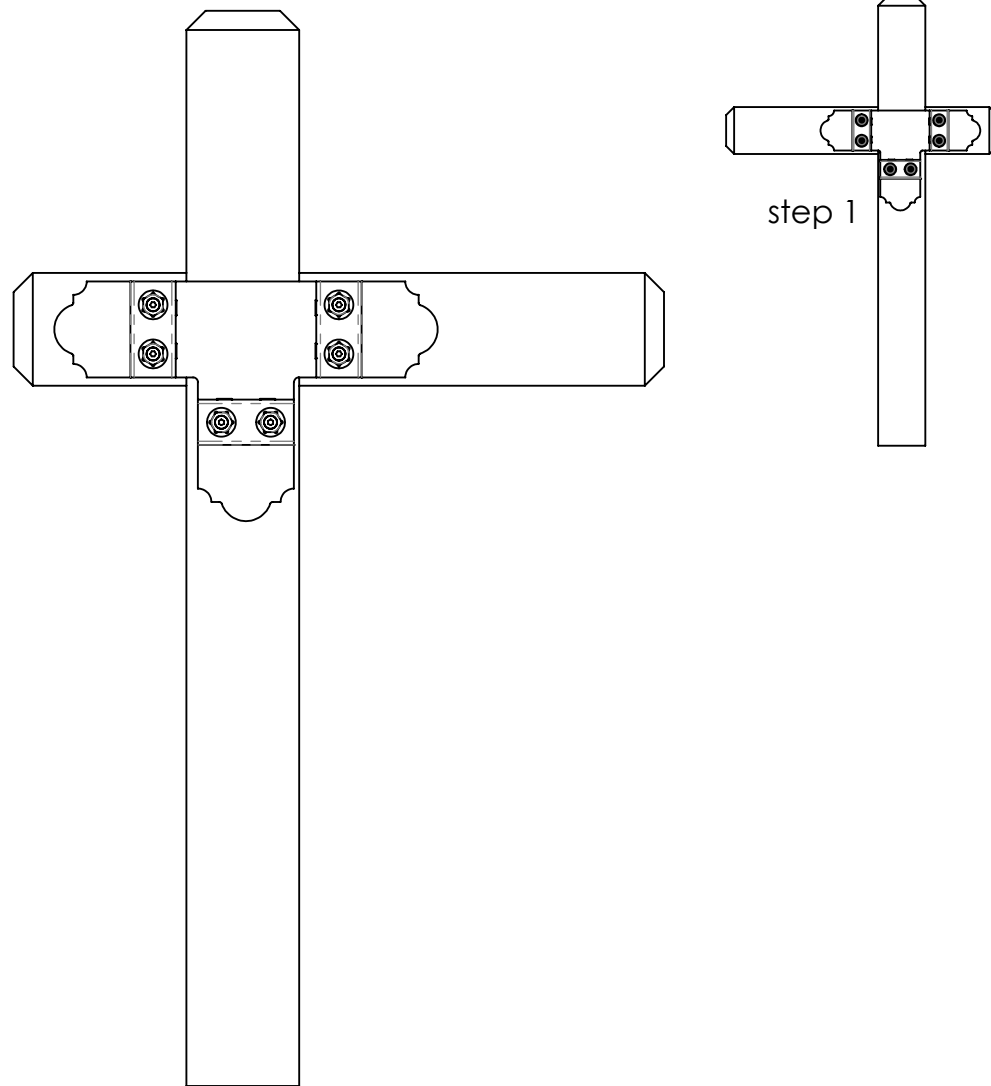

step 2
repeat step 1 on opposite side

OZCO Project #110 - Estate Wooden Mailbox Post Assembly with Post Base

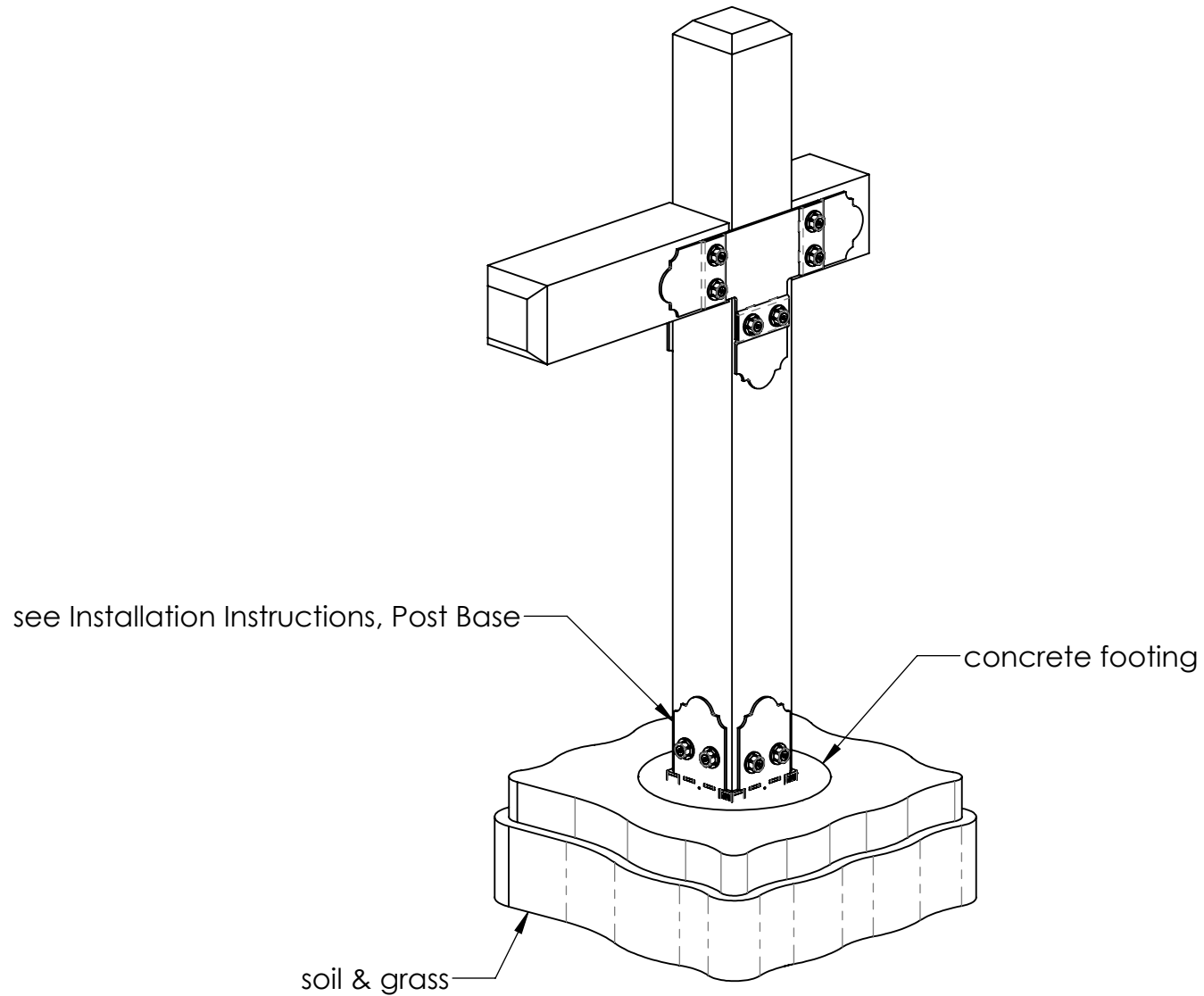

step 3

OZCO Project #110 - Estate Wooden Mailbox Post Assembly with Post Base

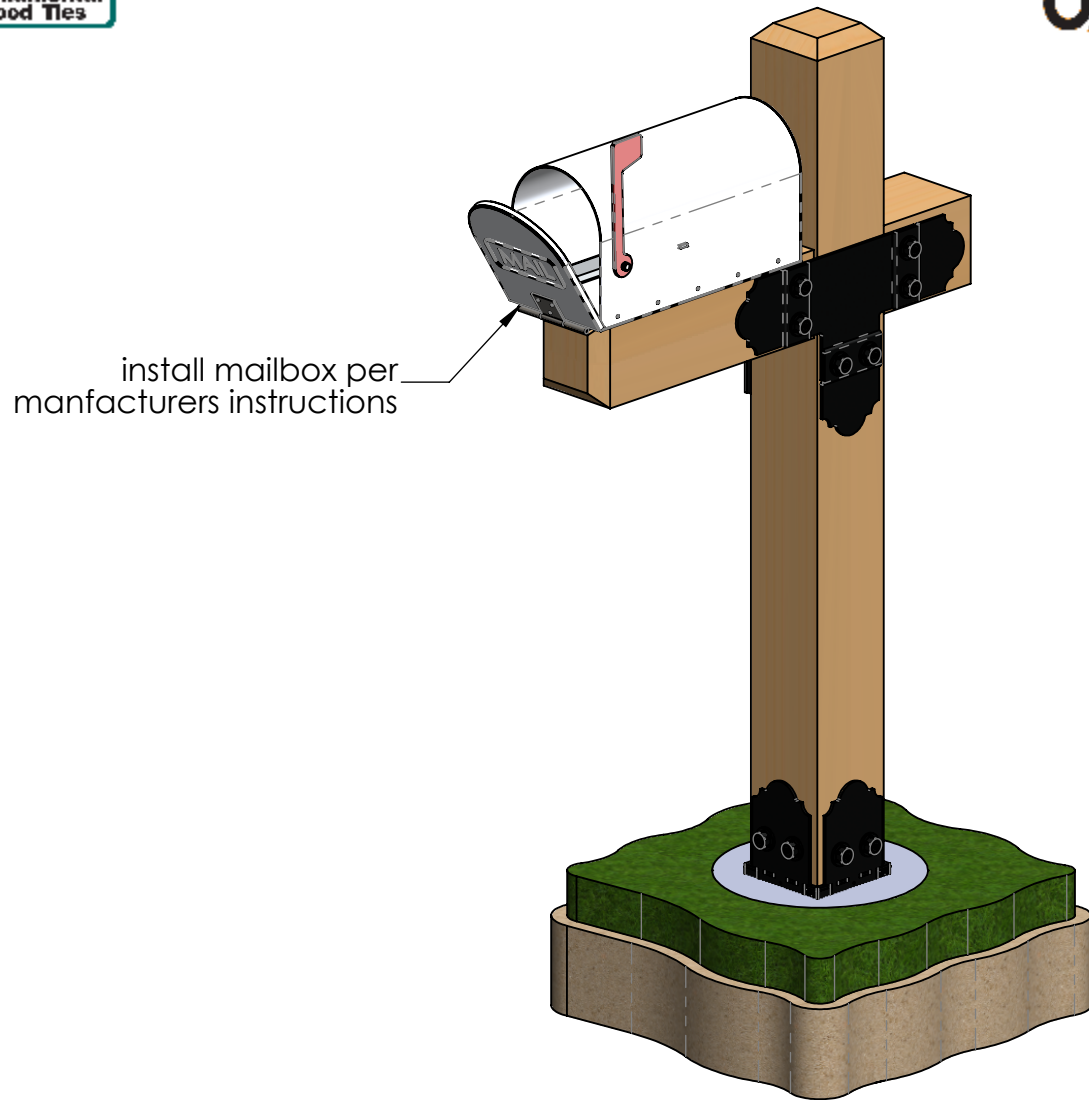

step 4

OZCO Project #110 - Estate Wooden Mailbox Post Assembly with Post Base